

Instructions of Networking Configuration for Data Logger (WiFi)

1. Open a wireless network.
2. Select logger network (network name: AP+SN) and connect. The password can be found on the logger label, which are the characters behind PWD.

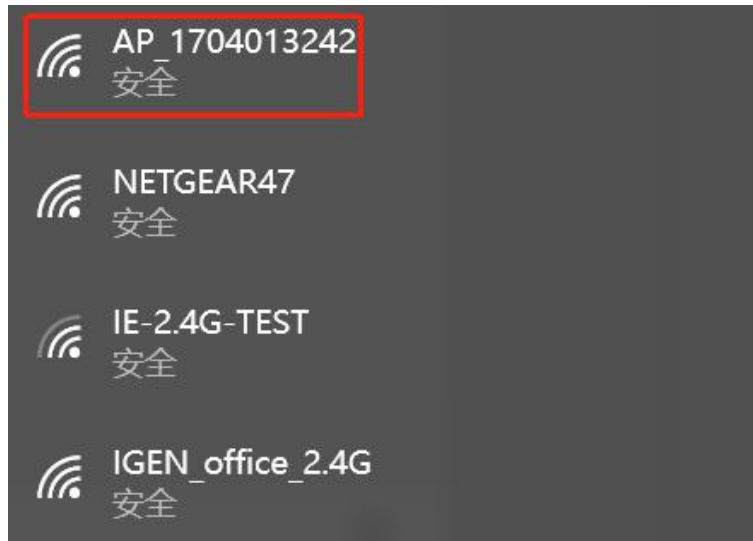

3. Open a browser and enter **10.10.100.254**. Both username and password are admin. (Recommended browser: IE 8+, Chrome 15+, Firefox 10+.)



4. Go to logger setup page. The basic information are listed here.

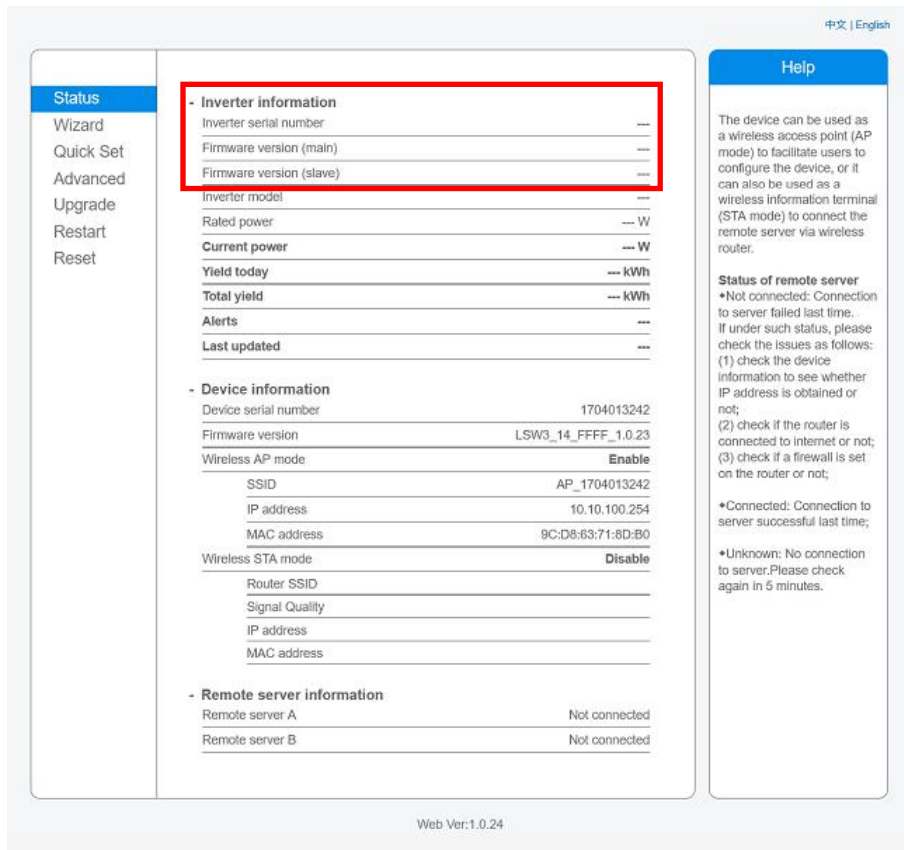

中文 | English

Status

- Wizard
- Quick Set
- Advanced
- Upgrade
- Restart
- Reset

- Inverter information

Inverter serial number	---
Firmware version (main)	---
Firmware version (slave)	---
Inverter model	---
Rated power	--- W
Current power	--- W
Yield today	--- kWh
Total yield	--- kWh
Alerts	---
Last updated	---

- Device information

Device serial number	1704013242
Firmware version	LSW3_14_FFFF_1.0.23
Wireless AP mode	Enable
SSID	AP_1704013242
IP address	10.10.100.254
MAC address	9C:D8:63:71:8D:B0
Wireless STA mode	Disable
Router SSID	
Signal Quality	
IP address	
MAC address	

- Remote server information

Remote server A	Not connected
Remote server B	Not connected

Web Ver:1.0.24

Help

The device can be used as a wireless access point (AP mode) to facilitate users to configure the device, or it can also be used as a wireless information terminal (STA mode) to connect the remote server via wireless router.

Status of remote server

- Not connected: Connection to server failed last time. If under such status, please check the issues as follows: (1) check the device information to see whether IP address is obtained or not; (2) check if the router is connected to internet or not; (3) check if a firewall is set on the router or not;
- Connected: Connection to server successful last time;
- Unknown: No connection to server. Please check again in 5 minutes.

5. Go to setup guide, click Refresh to search the wireless network. Select the target network and connect.

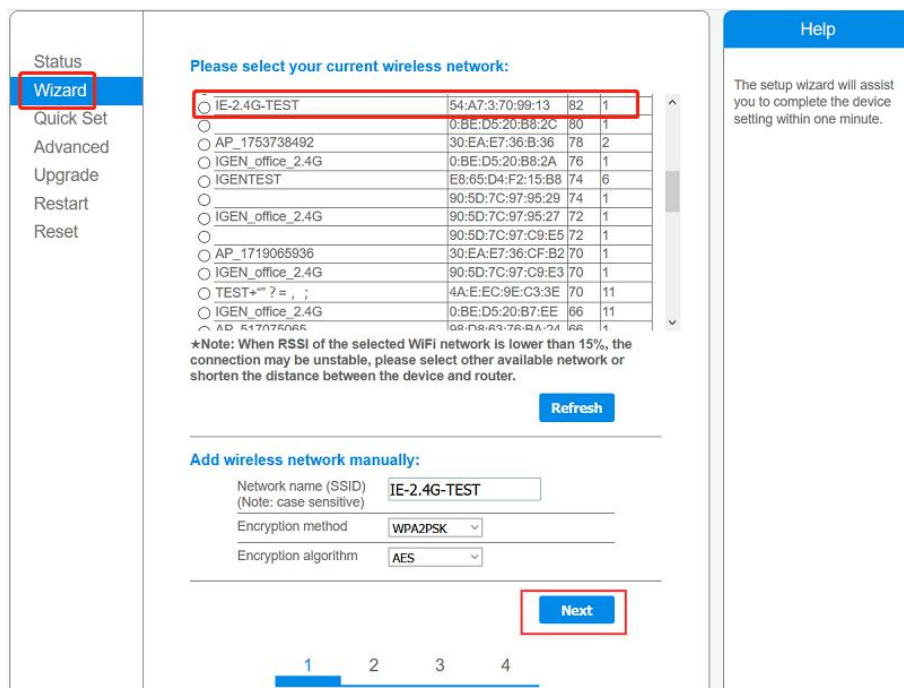

Status

- Wizard
- Quick Set
- Advanced
- Upgrade
- Restart
- Reset

Please select your current wireless network:

<input checked="" type="radio"/> IE-2.4G-TEST	54:A7:3:70:99:13	82	1
<input type="radio"/> AP_1753738492	0:BE:D5:20:B8:2C	80	1
<input type="radio"/> IGEN_office_2.4G	30:EA:E7:36:B:36	78	2
<input type="radio"/> IGEN_office_2.4G	0:BE:D5:20:B8:2A	76	1
<input type="radio"/> IGENTEST	E8:65:D4:F2:15:B8	74	6
<input type="radio"/>	90:5D:7C:97:95:29	74	1
<input type="radio"/> IGEN_office_2.4G	90:5D:7C:97:95:27	72	1
<input type="radio"/>	90:5D:7C:97:C9:E5	72	1
<input type="radio"/> AP_1719065936	30:EA:E7:36:CF:B2	70	1
<input type="radio"/> IGEN_office_2.4G	90:5D:7C:97:C9:E3	70	1
<input type="radio"/> TEST+™ ? = , ;	4A:E:EC:9E:C3:3E	70	11
<input type="radio"/> IGEN_office_2.4G	0:BE:D5:20:B7:EE	66	11
<input type="radio"/> AP_17075065	08:D8:63:76:BA:24	66	4

*Note: When RSSI of the selected WiFi network is lower than 15%, the connection may be unstable, please select other available network or shorten the distance between the device and router.

Refresh

Add wireless network manually:

Network name (SSID) (Note: case sensitive)

Encryption method

Encryption algorithm

Next

1 2 3 4

Help

The setup wizard will assist you to complete the device setting within one minute.

6. Enter the password and click Next.

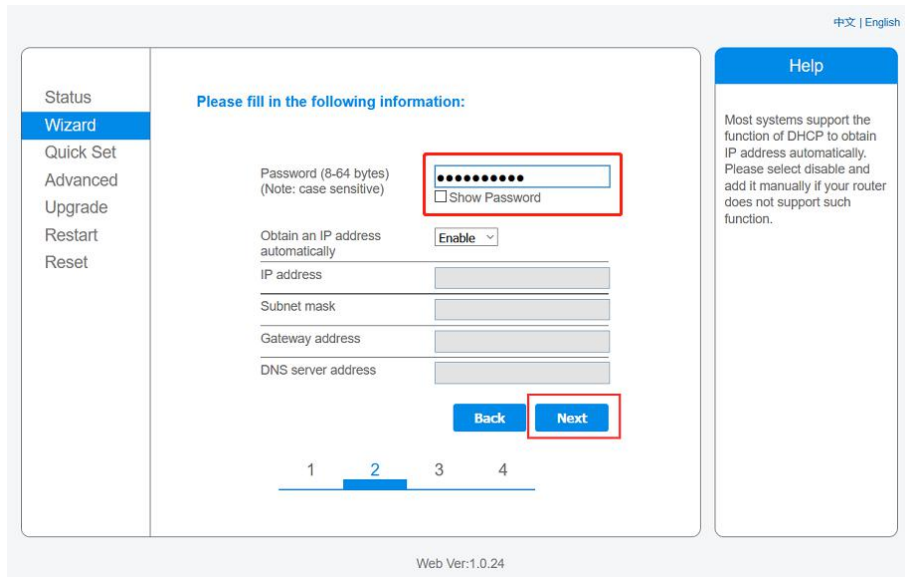

7. Users can select any options below to enhance the security and click Next.

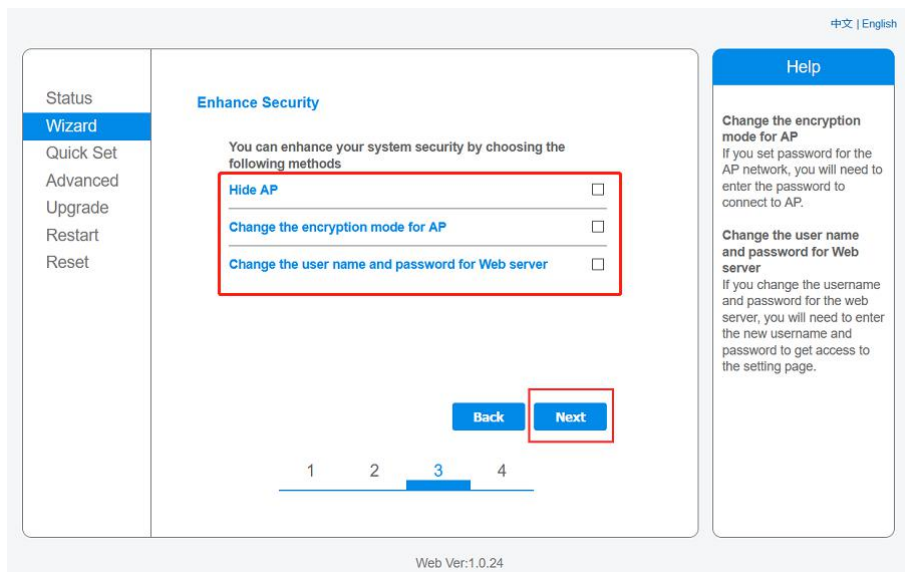

8. If the setup is successful, the following page will pop up and click OK to reboot the module.

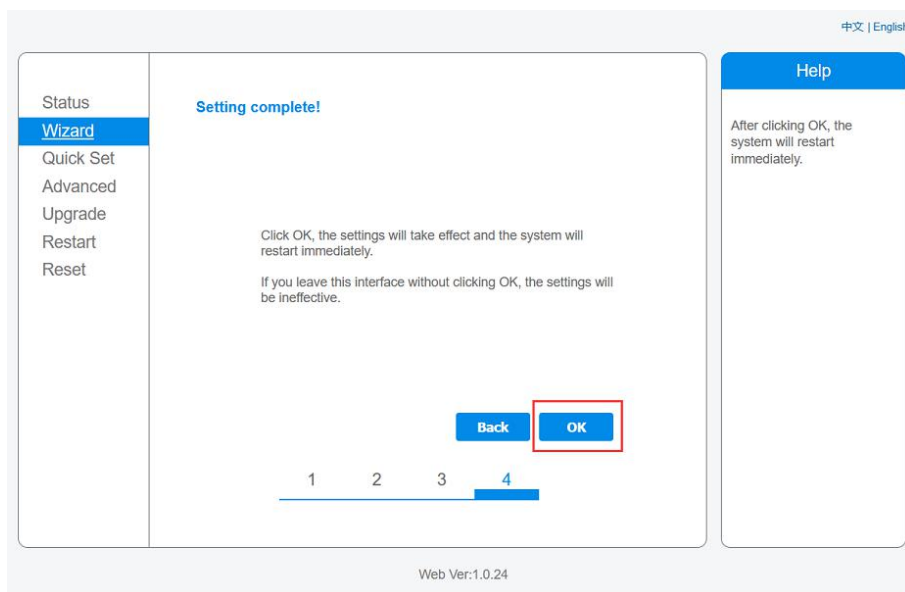

9. Log in to 10.10.100.254 again and check system info here. After the network setting is done, **wireless network STA mode is Enable**. The info of router will be displayed on the page and the remote server A is connectable.

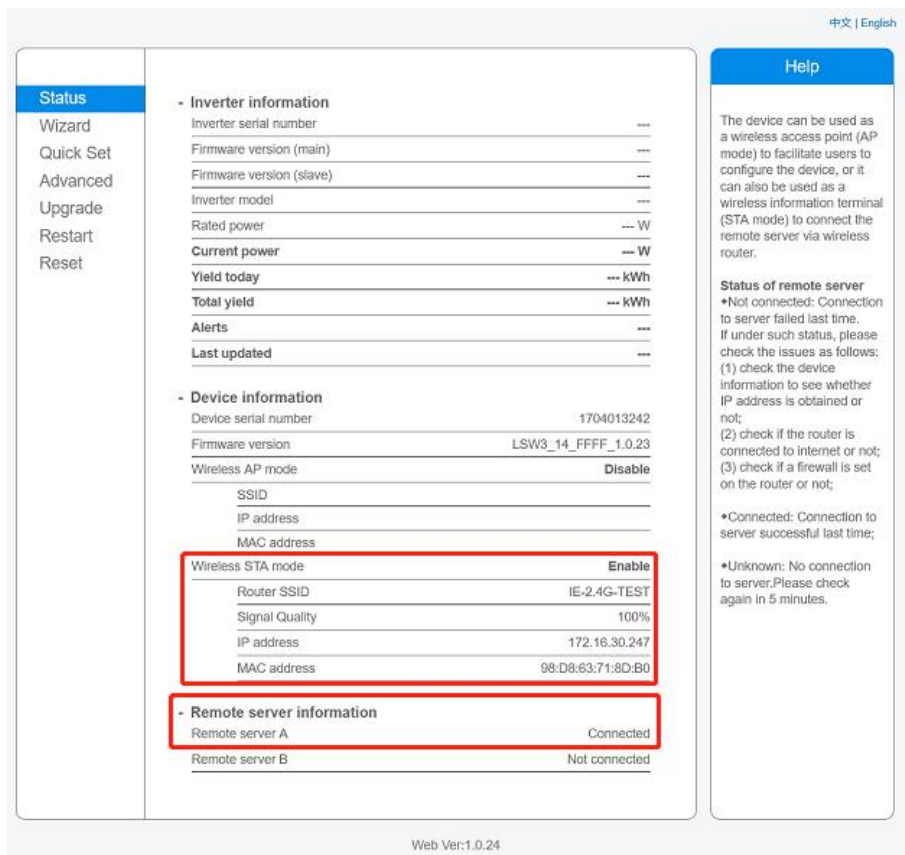

10. If the remote server is disconnectable, please refresh the page or try it again.